



Church Heating Seminar

Wiring Installation

John Morgan



The Church of England
Diocese of Ely

ely2025

Approval routes for wired heating installations

- **List A1(6)**
 - (6) Works of maintenance, repair and adaptation (not amounting to substantial addition or replacement but including rewiring) to existing ... (a) heating systems (including the replacement of control equipment and the insulation of pipes in the boiler room and ancillary service areas)
- **List B4**
 - (I0) The introduction of an electrical heating appliance not forming part of a heating system
 - (I0A) The installation of an electrical heating system for attachment to pews made in or after 1850 and which are not of historic interest
- **Faculty** – everything else

Details of the appliance(s), their proposed location, fixing, and the location of any cable runs are required for all applications

Example submission – St Peter Upwood

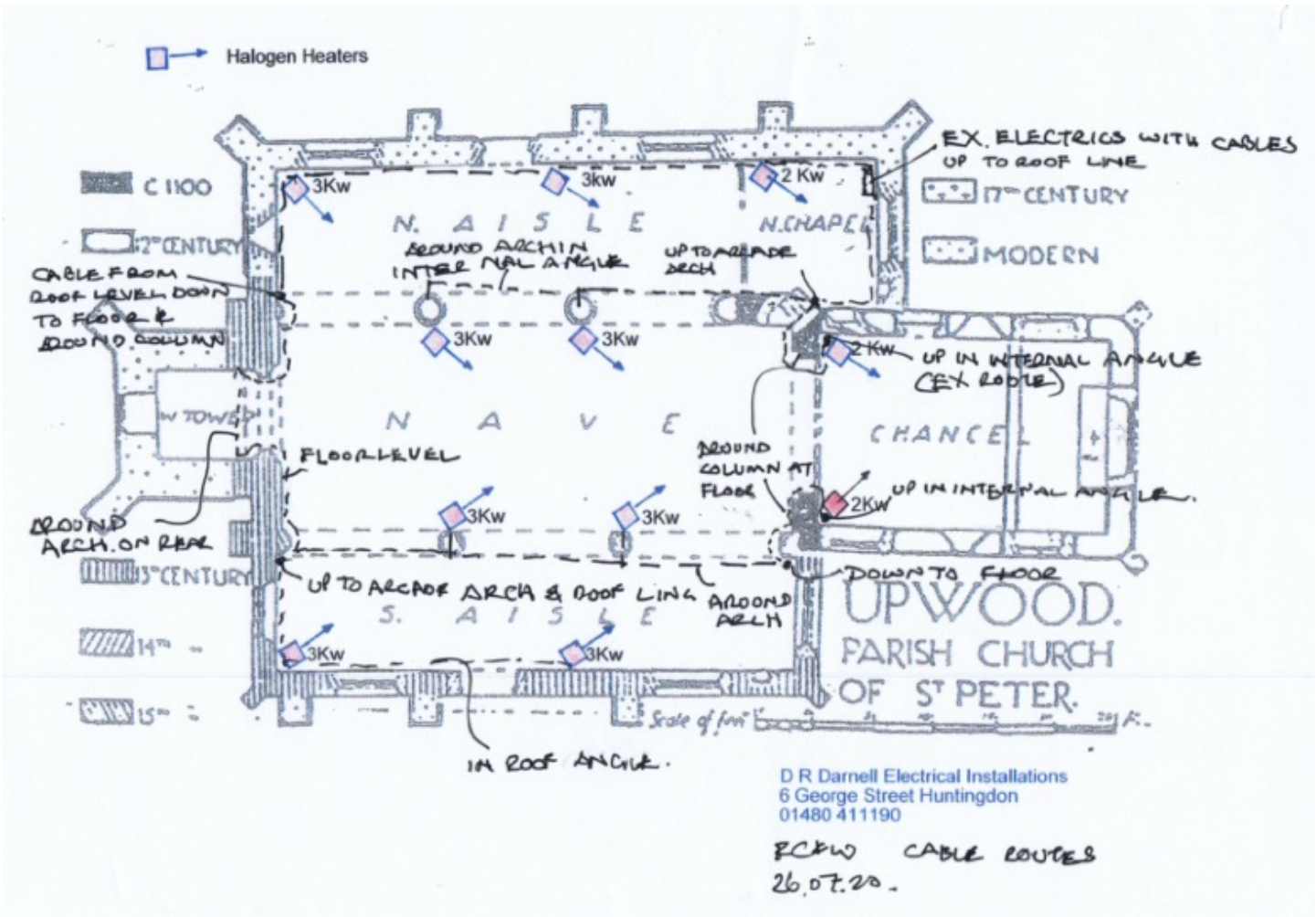

Example submission – St Peter Upwood

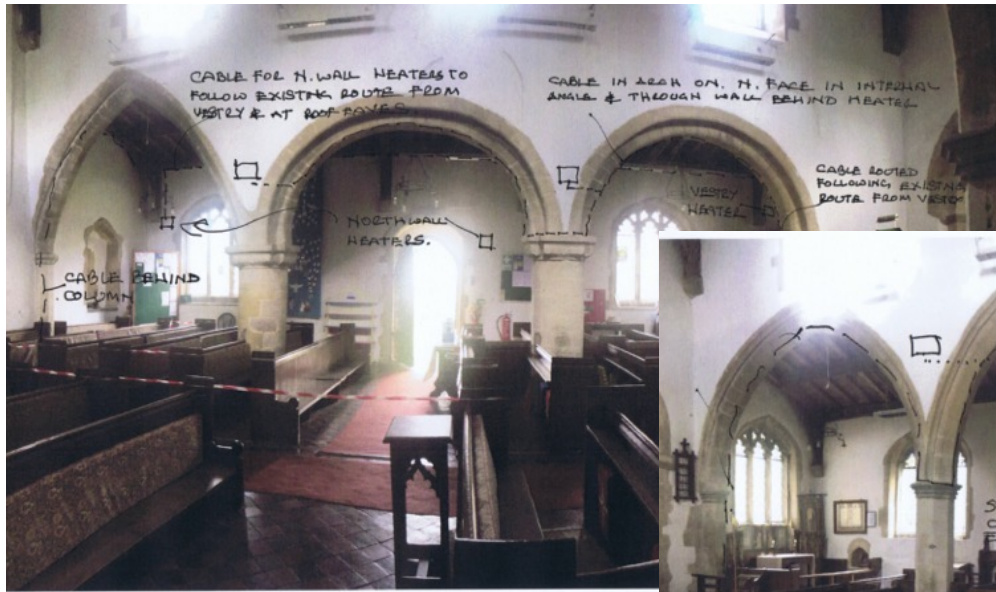

PETERS UPWOOD N. ARCADE – HEATER POSITIONS & WIRING ROUTES



PETERS UPWOOD S. ARCADE / S. WALL HEATERS & CABLE ROUTES

Example submission – St Peter Upwood



Example submission – St Mary Wisbech

Wiring Diagram sketch - St Mary Church, Wisbech, PE13

(patent & design: Kovoschmidt Ltd, installer & tester: McCarthy Electrical Limited, prepared on: 17/11/2022)

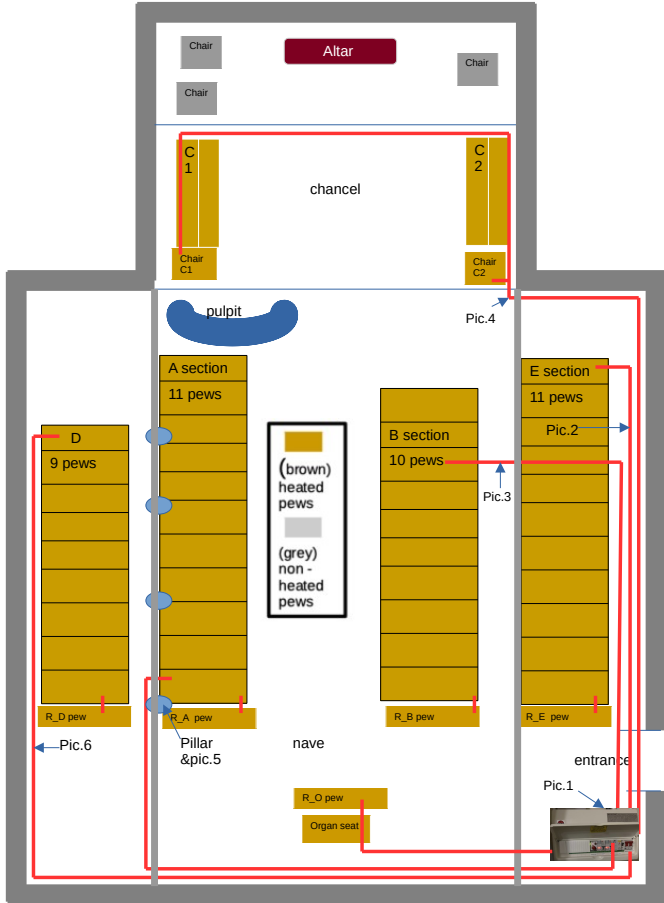

The control box and the pews section switch box will be positioned on the side window wall (no space for the 21 module consumer unit on the front because of the white pipe).



The cables would cross under the stairs next to the pipes at the entrance door.



The cables to E section would follow the existing pipes.

The mixture of NYJ-3 core- (TUF Sheeted) and FP200 cable will be used throughout the church..



Cable to A section.

Cable B section.



Because of the tiles between Section A and D, rather the cable coming down on the pillar to section A was chosen. The cable would come down on the wall side of the pillar to make it less obtrusive.

Typical provisos

- All cables, whether against the painted wall surface, stonework or woodwork will be coloured to match the background surface
- Cabling to the fittings at capital level will be run within the arches on the aisle sides, clipped to joints and coloured in to match the stonework.
- Cable fixings to be into mortar joints (not masonry)



Any questions?



The Church of England
Diocese of Ely

ely2025